



Ashville Park Community

The Covington II Floor Plan

Enter the stunning Covington floorplan through the charming front porch or through the three-car side load garage. What makes this garage special is its large storage area and drop zone by the door. Once inside the home, the great room, breakfast nook, and kitchen all flow together. The kitchen is only separated from the rest of the home by a large island. The kitchen also features a butler's pantry and a large food pantry. This whole open area is central in the home with the addition of an extended breakfast area. The first floor also offers a guest bedroom with a full bathroom making it the perfect setup for any friends or family who come to visit. A powder room is also on the first floor near the study and dining room. Enjoy the perfect office with glass doors to the study to make all your working-from-home colleagues jealous. The 4,956 square feet doesn't stop with one floor, up the stairs you will find three additional bedrooms, two full bathrooms, and a remote learning room. There is also a spacious loft at the top of the stairs that you can ...

\$1,409,410



5 Bedrooms



5.0 Bathrooms



4,956 Sq.Ft.



3 Stories



3 Car Garage

CONTACT US 757-550-2617

WWW.CESHOMES.COM



FIRST FLOOR



CONTACT US 757-550-2617

WWW.CESHOMES.COM



SECOND FLOOR



CONTACT US 757-550-2617

WWW.CESHOMES.COM



THIRD FLOOR

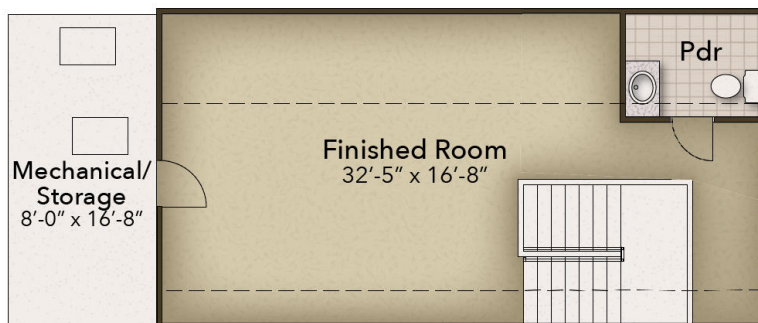

CONTACT US 757-550-2617

WWW.CESHOMES.COM

