



River Club Community

The Berkeley Floor Plan

\$859,900

Welcome Home to The Berkeley! The Berkeley is the picture-perfect floorplan for those looking for storage and space. As soon as you open your front door, you are welcomed by an open dining room to one side of the foyer and a Study on the other side. A powder room can be found on this level, also. The dining room is connected to the kitchen by a butler's pantry and spacious kitchen pantry. Then continue through the kitchen past the large, gourmet kitchen island, to find your breakfast nook and rear covered porch access. The Owner's Suite and laundry room are also found on the first floor right past the open great room. With a fireplace in the great room, your movie night and fall evenings will be even better in your new home. The owner's suite features stunning tray ceilings, two large walk-in closets, and a spacious owner's deluxe bathroom. Head upstairs to find an open loft, perfect for that dream movie room, playroom, or gym you've been hoping for. The second floor of The Berkeley also features three more bedrooms and a two full baths. With all these incredible features, The Berkeley makes ...



4 Bedrooms



3.5 Bathrooms



3,175 Sq.Ft.



2 Stories



3 Car Garage

CONTACT US 757-550-2617

WWW.CESHOMES.COM



Chesapeake Homes continuously improves home designs and reserves the right to modify home features and specifications without notice or obligation. Square footage and measurements are approximate. Renderings of elevations are artist's concepts. Floor plans vary per elevation. Chesapeake Homes standard features vary by home design and location, please refer to the included features sheet for the community to define specifications. This brochure is for illustrative purposes and not part of the legal contract. Please ask Sales Associate for complete details. © 2025 Chesapeake Homes. Current information as 25th April 2025.



CONTACT US 757-550-2617

WWW.CHESHOMES.COM



Chesapeake Homes continuously improves home designs and reserves the right to modify home features and specifications without notice or obligation. Square footage and measurements are approximate. Renderings of elevations are artist's concepts. Floor plans vary per elevation. Chesapeake Homes standard features vary by home design and location, please refer to the included features sheet for the community to define specifications. This brochure is for illustrative purposes and not part of the legal contract. Please ask Sales Associate for complete details. © 2025 Chesapeake Homes. Current information as 25th April 2025

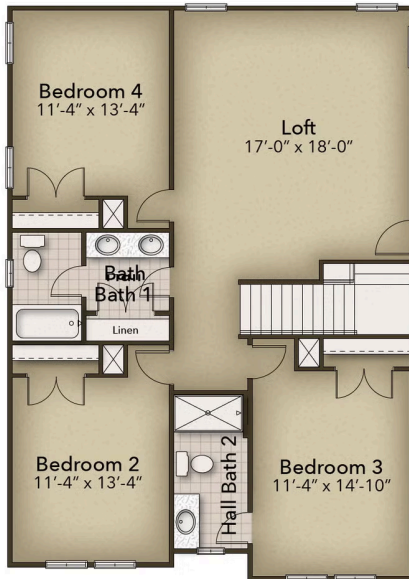

CONTACT US 757-550-2617

WWW.CHESHOMES.COM



Chesapeake Homes continuously improves home designs and reserves the right to modify home features and specifications without notice or obligation. Square footage and measurements are approximate. Renderings of elevations are artist's concepts. Floor plans vary per elevation. Chesapeake Homes standard features vary by home design and location, please refer to the included features sheet for the community to define specifications. This brochure is for illustrative purposes and not part of the legal contract. Please ask Sales Associate for complete details. © 2025 Chesapeake Homes. Current information as 25th April 2025