



Bridgewater - Waterside Village Community

The Sweetbay Floor Plan

With 2,537 square feet of living space, The Sweetbay is a spacious retreat complete with coastal-inspired architectural accents, spacious outdoor living spaces, and a wide-open floor plan. This home features a first-floor owner's suite with a generously sized sitting area. Enter The Sweetbay from the spacious covered porch into a large foyer with your drop zone to the left that connects you to your two-car garage. The drop zone leads to your laundry room perfect for hiding day-to-day messes. To your right is two bedrooms separated by a full bathroom. Down the hall leads you to a wide-open floorplan with your kitchen perfectly overlooking the great room and large covered rear porch. The owner's suite features a large walk-in closet alongside a luxurious bathroom that feels like a true retreat featuring a seated shower. Upstairs you will find a huge loft space with an additional walk-in closet alongside the 4th bedroom and full bathroom. This home features so many options to make sure it fits your family's needs, call The Sweetbay home today!

\$595,532



3 Bedrooms



3.0 Bathrooms



2,537 Sq.Ft.



2 Stories



2 Car Garage

FIRST FLOOR



CONTACT US 757-550-2617

WWW.CESHOMES.COM



SECOND FLOOR

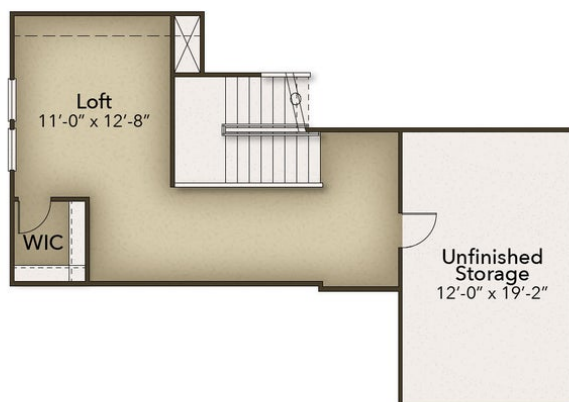

CONTACT US 757-550-2617

WWW.CESHOMES.COM

