



## Albemarle Plantation Community

### The Shorebreak Floor Plan

Welcome to The Shorebreak- a spacious model starting at 2,326 square feet, offering up to four bedrooms, three bathrooms, and boasting an optional second floor above a two-car garage included with the floor plan. As you step in from the covered front porch, you'll be greeted with an inviting open kitchen, complete with quartz countertops, light gray cabinets, and a Moen stainless steel faucet. The gourmet kitchen island is perfect for either hosting guests or everyday meal prep. Enjoy your meals in the casual dining space or on the expansive covered porch, ideal for warm summer evenings or afternoon get-togethers. The living area is cozy and comfortable, with beautiful Mohawk Wood Laminate flooring for a cohesive feel throughout the space. Beyond the open living area lies a stunning first-floor Owner's Suite, complete with a tray ceiling and an enormous walk-in closet. The Deluxe Owner's Bath comes with a large tiled shower, double vanity with blue cabinets, and beautiful Moen brushed nickel plumbing fixtures for a sleek finish. The second floor comes with a loft and a large unfinished storage area, which could be utilized as a recreational or media ...

**\$459,900**

-  **3 Bedrooms**
-  **2.0 Bathrooms**
-  **2,326 Sq.Ft.**
-  **2 Stories**
-  **2 Car Garage**

**CONTACT US 757-550-2617**

**WWW.CHESHOMES.COM**



Chesapeake Homes continuously improves home designs and reserves the right to modify home features and specifications without notice or obligation. Square footage and measurements are approximate. Renderings of elevations are artist's concepts. Floor plans vary per elevation. Chesapeake Homes standard features vary by home design and location, please refer to the included features sheet for the community to define specifications. This brochure is for illustrative purposes and not part of the legal contract. Please ask Sales Associate for complete details. © 2025 Chesapeake Homes. Current information as 19th April 2025.



## FIRST FLOOR



CONTACT US 757-550-2617

WWW.CESHOMES.COM



Chesapeake Homes continuously improves home designs and reserves the right to modify home features and specifications without notice or obligation. Square footage and measurements are approximate. Renderings of elevations are artist's concepts. Floor plans vary per elevation. Chesapeake Homes standard features vary by home design and location, please refer to the included features sheet for the community to define specifications. This brochure is for illustrative purposes and not part of the legal contract. Please ask Sales Associate for complete details. © 2025 Chesapeake Homes. Current information as 19th April 2025

## SECOND FLOOR

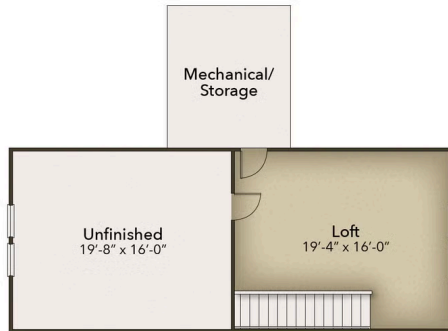

CONTACT US 757-550-2617

WWW.CHESHOMES.COM



Chesapeake Homes continuously improves home designs and reserves the right to modify home features and specifications without notice or obligation. Square footage and measurements are approximate. Renderings of elevations are artist's concepts. Floor plans vary per elevation. Chesapeake Homes standard features vary by home design and location, please refer to the included features sheet for the community to define specifications. This brochure is for illustrative purposes and not part of the legal contract. Please ask Sales Associate for complete details. © 2025 Chesapeake Homes. Current information as 19th April 2025