



## From \$313,900

Starting at almost 1,700 square feet, the Cherry Grove is a spacious retreat complete with coastal-inspired architectural accents, outdoor living areas, and a large great room. This unique model offers an optional second floor, creating a home that features up to four bedrooms and three full bathrooms. Enter Cherry Grove from a covered front porch or two-car garage and easily unload in a large drop zone connected to the laundry area with an optional bench for seating. Personalize your kitchen in this model with the choice between two floorplan options. From the great room transition to either a picturesque covered porch that you can utilize year-round. Here, you'll enjoy peaceful evenings or a morning sunrise right from your back door! The owner's suite, among two additional first-floor bedrooms, features a large walk-in closet, tray ceiling, double vanity, and deluxe seated shower option. Also, add a second floor for a fourth bedroom, additional bathroom, loft, or unfinished storage space. With endless possibilities for personalizing this model, the Cherry Grove is bound to be your perfect fit!



2 Bedrooms



2.0 Bathrooms



1,672 Sq.Ft.



1 Stories



2 Car Garage

**CONTACT US 757-550-2617**

**WWW.CESHOMES.COM**

**FIRST FLOOR**



**CONTACT US 757-550-2617**

**WWW.CESHOMES.COM**



## SECOND FLOOR

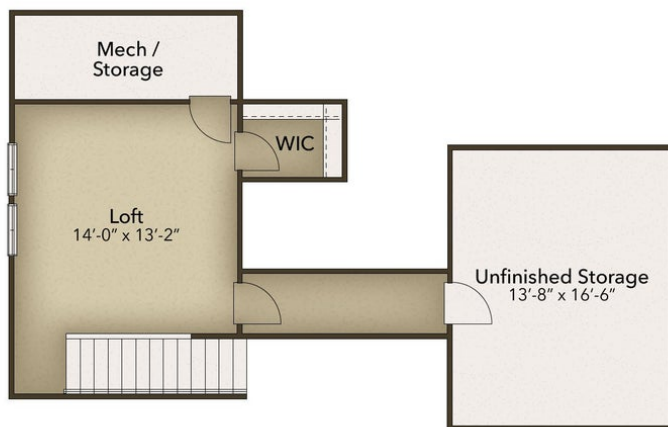

**CONTACT US 757-550-2617**

**WWW.CESHOMES.COM**

